

CHF 1111 MCN

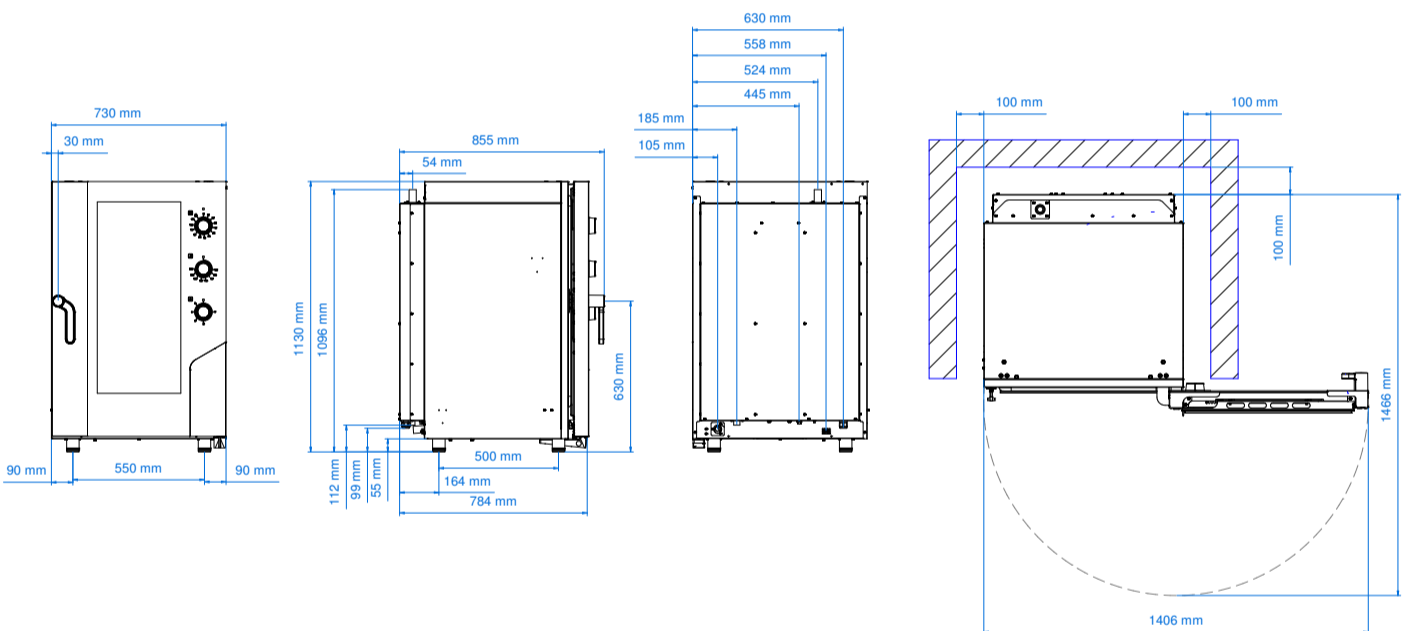

Electric combi oven 11 trays 1/1 GN with electromechanic panel

The 11 1/1 GN tray MILLENNIAL SMART oven, simple, but at the same time complete CHF 1111MCN is controlled by an electromechanical panel that will ensure even cooking also thanks to the 68 mm pitch, an inter-space that distinguishes the MILLENNIAL 1/1 GN ovens.



Plus

Available on request at the order	Voltage (V) : AC 220/230 3 PH
	Left side opening door *
Adjustable door hinges	

Equipment

Cardboard box dimensions with pallet (WxDxH mm)	788 x 905 x 1276
Lateral supports	1 right + 1 left
Cable	Three-phase+neutral [5G 4]-L=1600 mm
Manual washing predisposition	
Condensate collection bowl, with drain on door	
Hinge with door locking for openings adjusted at 60°, 90°, 120°, 180°	

Dimensional features

Dimensions (WxDxH mm)	730 x 855 x 1130
Weight (kg)	113,8
Distance between rack rails (mm)	68

Electrical features

Power supply (kW)	15,4
Frequency (Hz)	50/60
Voltage (V)	AC 380/400 3N
N° motors	2 bidirectionals
Boiler (kW)	/
Protection against water	IPX4

Functional features

Power	Electricity
Capacity	N° 11 trays/grids 1/1 GN
Type of cooking	Ventilated
Steam	Direct steam controlled by knob (5 levels)
Cooking chamber	AISI 304 stainless steel
Temperature	100 - 270 °C
Temperature control	Thermostat
Control panel	Electromechanic - right side
N° programs	/
Programmable cooking steps	/
Pre-heating temperature	/
Pre-heating function	/
Door	Right side opening Ventilated Inspectionable glass
Modularity	Yes
Feet	Adjustable