

# CHF 1664 MCN

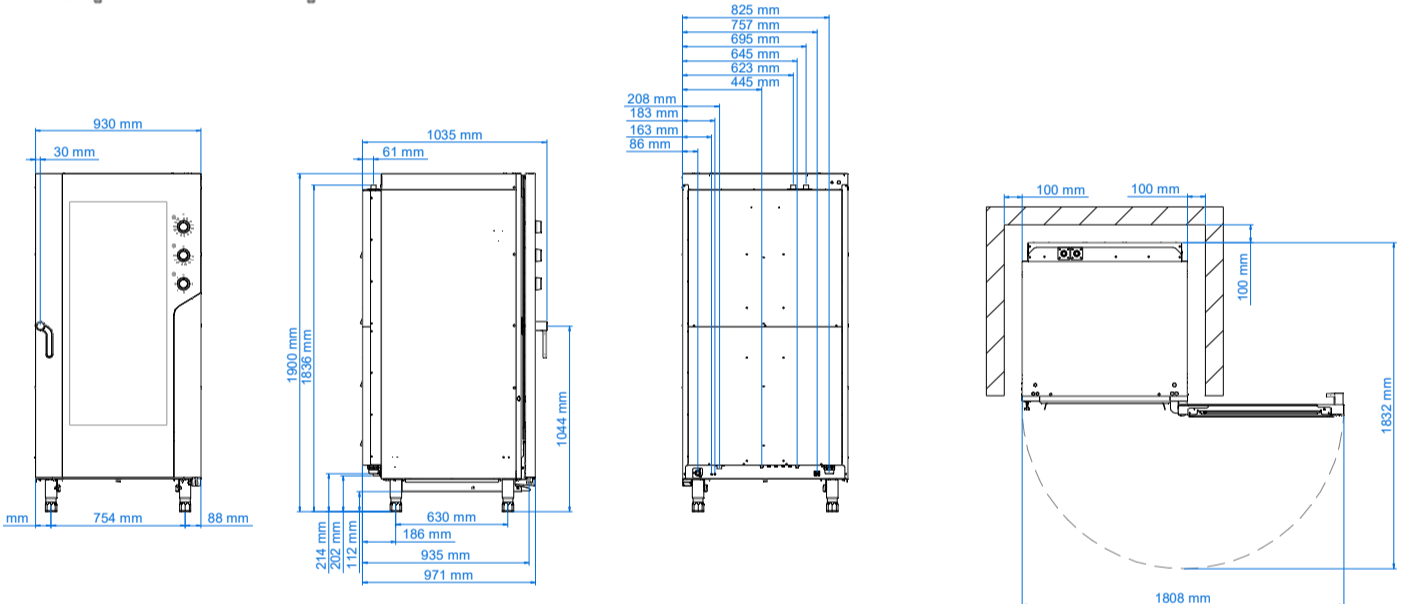

## Electric combi oven 16 trays 600 x 400 mm with electromechanic panel

Designed for handling a large quantity of oven-cooked food, the CHF 1664 MCN is the convection steam oven with electromechanical panel equipped with three selectors for time, temperature and steam. The new MIL-LENNIAL SMART oven simultaneously bakes all your preparations on the 16 trays of the trolley at the same time, ensuring homogeneous cooking through the optimal ventilation of the 4 fans arranged vertically and at the temperature range of 100 to 275°C.



### Plus

Available on request at the order Voltage (V) : AC 220/230 3 PH  
Left side opening door \*  
 Adjustable door hinges

### Equipment

Cardboard box dimensions with pallet (WxDxH mm) 1146 x 1260 x 2090  
 Manual washing predisposition  
 Hinge with door locking for openings adjusted at 60°, 90°, 120°, 180°  
 Trolley with removable handle and braked wheels cod. EKCR 16 TC

### Dimensional features

Dimensions (WxDxH mm) 930 x 1041 x 1900  
 Weight (kg) 247,2  
 Distance between rack rails (mm) 80

### Electrical features

|                          |                  |
|--------------------------|------------------|
| Power supply (kW)        | 31               |
| Frequency (Hz)           | 50/60            |
| Voltage (V)              | AC 380/400 3N    |
| N° motors                | 4 bidirectionals |
| Boiler (kW)              | /                |
| Protection against water | IPX4             |

### Functional features

|                            |  |
|----------------------------|--|
| Power                      | Electricity  |
| Capacity                   | N° 16 trays/grids 600 x 400 mm                           |
| Type of cooking            | Ventilated   |
| Steam                      | Direct steam controlled by knob (5 levels)               |
| Cooking chamber            | AISI 304 stainless steel                                 |
| Temperature                | 100 - 270 °C   |
| Temperature control        | Thermostat   |
| Control panel              | Electromechanic - right side                             |
| N° programs                | /  |
| Programmable cooking steps | /  |
| Pre-heating temperature    | /  |
| Pre-heating function       | /  |
| Door                       | Right side opening<br>Ventilated<br>Inspectionable glass |
| Feet                       | Adjustable   |